

PUKING ZOMBIE™

INSTALLATION AND OPERATING INSTRUCTIONS

KEEP ALL PLASTIC AND WIRE PARTS AWAY FROM CHILDREN

WARNING: DO NOT TURN ON THE PROP UNTIL FULLY ASSEMBLED. STAY CLEAR OF THE PROP WHILE OPERATING.

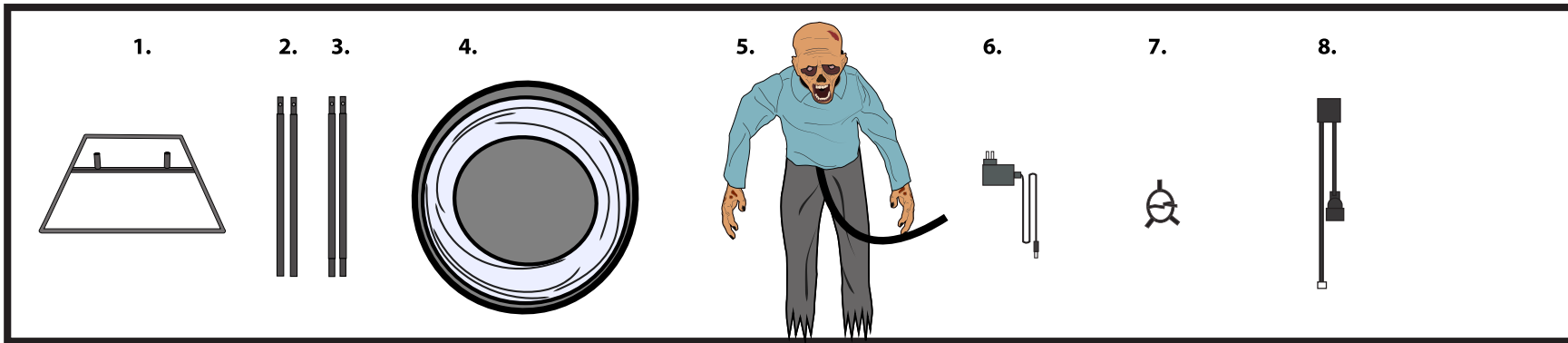

Parts:

1. STAND
2. UPPER POLES
3. LOWER POLES
4. FABRIC DRUM
5. BODY WITH PANTS
6. ADAPTER
7. METAL CLIP
8. FOG CORD

IMPORTANT : REQUIRES FOG MACHINE FOR USE

1. Attach LOWER SNAP LOCK POLES to STAND. (Match A to A) Poles are secure when the snap lock pins snap into place.
2. Attach UPPER SNAP LOCK POLES to LOWER SNAP LOCK POLES assembled to STAND. (Match B to B) Poles are secure when the snap lock pins snap into place.
3. Slide BODY WITH PANTS over UPPER and LOWER POLES. Snap lock the BODY WITH PANTS to UPPER POLES. (Match C to C) and (Match D to D)
4. Locate the two metal grommets on front of the shirt. Place the metal grommets over the two metal hooks (labeled E) located on the front of the metal frame.
5. Attach the hook and loop fastener located on the pants to the hook and loop fastener located under the shirt.
6. Release the fabric loops on the sides of the FABRIC DRUM. Insert the wire from the FABRIC DRUM through the grommet located on the front of the shirt.
7. Locate the two hooks on front of the shirt. Hook the top of the drum over the two metal hooks sticking out from the front of the shirt. (Match E to E)
8. Connect the wire from the FABRIC DRUM to the back of the MODULE located under the shirt. (Match F to F)
9. Proceed to Fog Machine Setup.

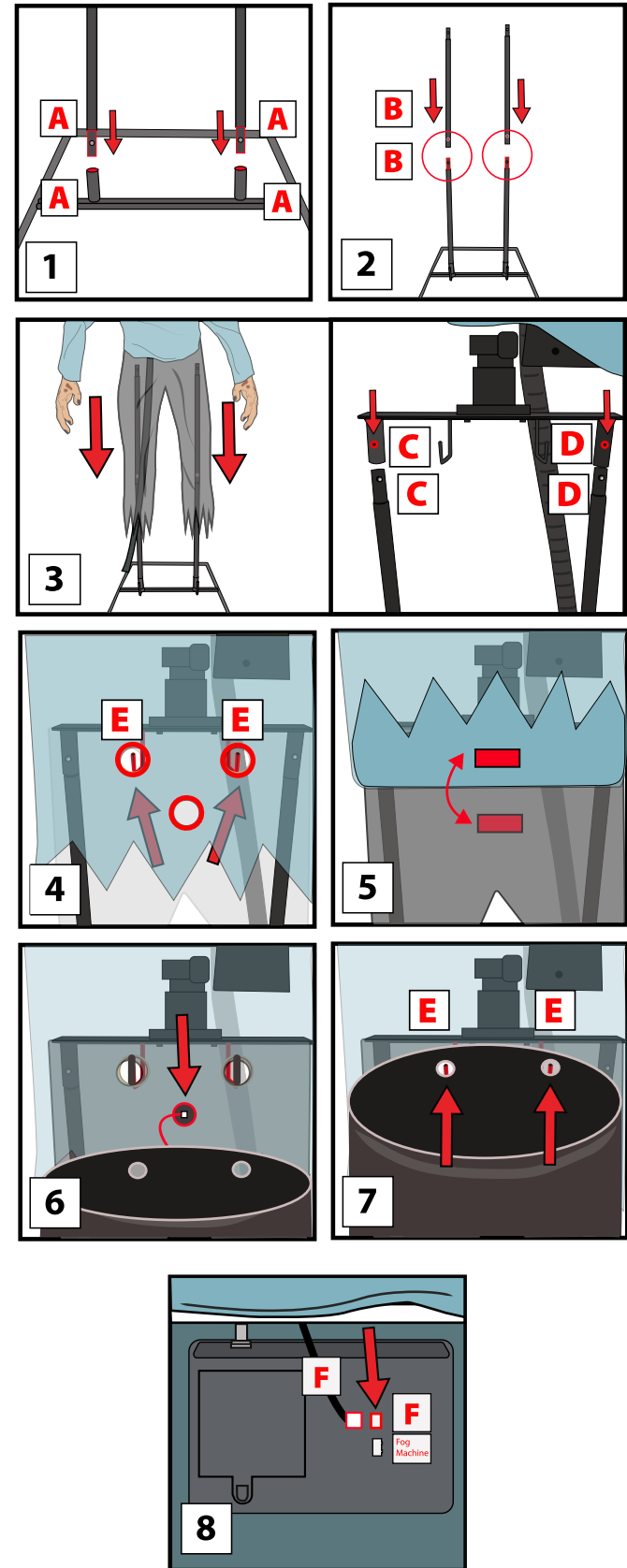

9 FOG MACHINE SETUP INSTRUCTIONS: FOG MACHINE NOT INCLUDED. MUST BE PURCHASED SEPARATELY.

1.

2.

3.

4.

FOG ATTACHMENT SETUP

Your fog machine (select models) can be used in connection with select items.
Only attach a fog machine as instructed below.

Make sure Item is set to the OFF position and your fog machine is not turned on

1. Install METAL CLIP and Puking Zombie's™ FOG HOSE onto your fog machine. (Note: leave about 1.5 inches space between fog machine nozzle and the end of the FOG HOSE, or FOG HOSE may melt).
2. Plug the FOG CORD into your FOG MACHINE. If FOG CORD will not plug in, or your machine does not interface with the item, we recommend that your not use optional fog attachment.
3. Plug other end of FOG CORD (labeled M) into MODULE of Puking Zombie™ marked Fog Machine. (Match M to M)
4. Make sure your fog machine is heated up properly before turning Puking Zombie's™ switch to the ON position. (If fog does not appear from item, try pressing the relay switch button on the MODULE.)

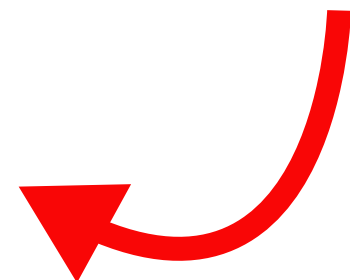

PUKING ZOMBIE™

INSTALLATION AND OPERATING INSTRUCTIONS

KEEP ALL PLASTIC AND WIRE PARTS AWAY FROM CHILDREN

WARNING: DO NOT TURN ON THE PROP UNTIL FULLY ASSEMBLED. STAY CLEAR OF THE PROP WHILE OPERATING.

10. Insert 6V 2A ADAPTER (included) or 4 AA batteries (not included) into the battery compartment located on MODULE.

*NOTE: Turn switch to the ON position to operate in sound activation mode. Make a loud sound (clap), to activate. Turn item OFF when not in use. Adjust Volume Control knob as needed.

11. Position the hands on the edge of the FABRIC DRUM as seen in the photo below.

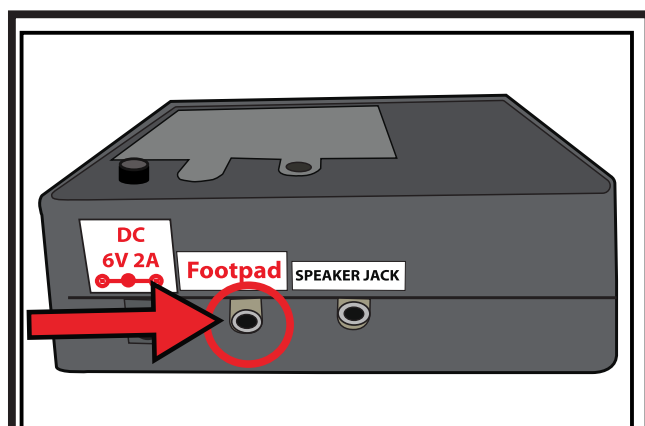
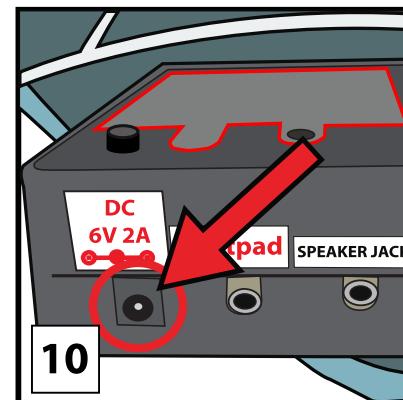

OPTIONAL FOOTPAD SETUP

1. Connect the cable from the optional footpad to the jack labeled FOOTPAD located on the MODULE.
2. Place the switch on the MODULE into the 'FOOTPAD' position to enable FOOTPAD activation.
3. Step on FOOTPAD to activate the scary sequence.

*Footpads are sold separately and can be purchased at tekkyaccessories.com

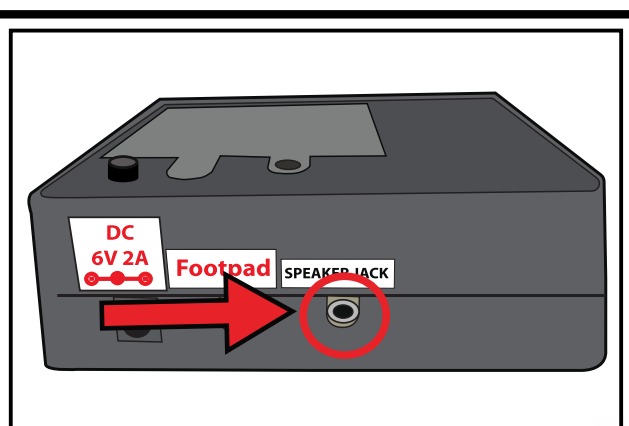

OPTIONAL EXTERNAL SPEAKER SETUP INSTRUCTIONS

EXTERNAL SPEAKER NOT INCLUDED. MUST BE PURCHASED SEPARATELY.

1. Plug speaker cord into the jack labeled SPEAKER JACK located on the top of the base.
2. Use volume knob on external speaker to control volume levels.

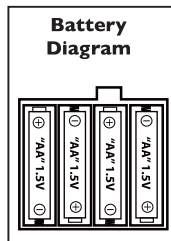

BATTERY INSTRUCTIONS AND CAUTIONS

Battery installation and removal should be performed by an adult. Remove batteries when not in use. Use only batteries recommended in the instructions. Do not mix new and used batteries. Do not mix alkaline, carbon-zinc, nickel-cadmium, rechargeable or different types of batteries. Be mindful to insert batteries with the correct polarity (+/-) as indicated. Remove all exhausted batteries. Rechargeable batteries are only to be charged under adult supervision. Rechargeable batteries are to be removed from the item before being charged. Non-rechargeable batteries are not to be recharged. The supply terminals are not to be short-circuited. Always dispose of exhausted batteries properly. Do NOT dispose of batteries in fire, they may leak or explode.

Warning! This item is not a toy. For decoration only. Small parts, choking hazard. This product is intended for use by persons 15 years of age and older. Not intended for use by children ages 14 years and younger.

WARNING
DO NOT TURN ITEM ON UNTIL YOU HAVE COMPLETELY FINISHED ASSEMBLY.
STAY CLEAR OF ITEM WHILE OPERATING.
DO NOT PLACE ITEM ON UNEVEN GROUND.
DO NOT PLACE WEIGHT ON ITEM WHILE IN OPERATION.
**** FOR INDOOR USE ONLY****

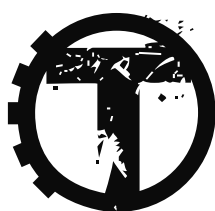

TEKKY

visit us at tekkydesign.com

Requires 6V 2A ADAPTER (included) or 4 AA batteries (not included)

ALL NEW MATERIALS:
METAL, FOAM, PLASTIC, POLYESTER
Surface washable only.

PUKING ZOMBIE™ is a trademark of Tekky.

Copyright © 2020 Tekky.

All Rights Reserved.

MADE IN CHINA



DO NOT RETURN THIS ITEM TO THE STORE!
If experiencing technical difficulties, please go to www.tekkydesign.com for assistance.

SMART PHONE SCAN
SETUP VIDEO

